

LANCE SCHIUMA A MEDIA ESPANSIONE Mod. FI – LME - P MEDIUM EXPANSION FOAM MAKERS Mod. FI – LME - P



Caratteristiche Tecniche

- Resa schiuma: 1/60 con schiumogeno sintetico per alta e media espansione
- Tronchetto porta ugello ed ugello in inox
- Reti interne d'omologazione miscela inox
- Corpo lancia in inox
- Connessione: UNI 45 o BSS

Technical Characteristics

- Foam production: 1/60 with syntetic foam compound suitable for high and medium expansion
- Pipe and nozzle in inox
- Internal homogenization net are made in inox
- Body foam maker are made of inox
- Connection: UNI 45 or BSS

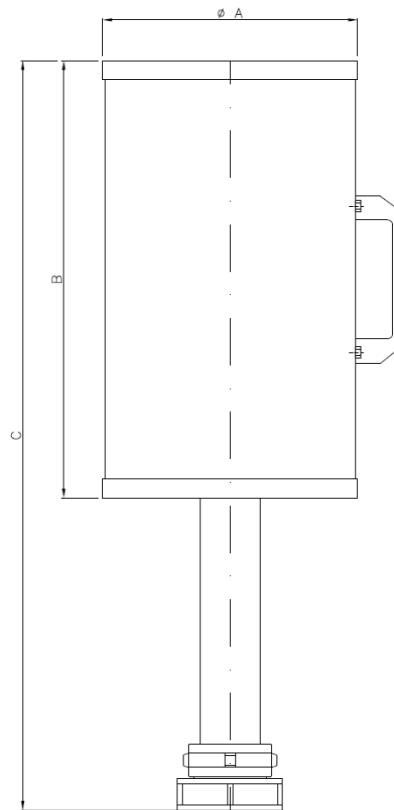

MODELLO	PORTATA A 5 BAR	A	B	C	PESO KG.
MODEL	CAPACITY AT 5 BAR	mm	mm	mm	WEIGHT KG.
FI-LME-P 2-4	200 - 400 Lts	204	350	600	6
FI-LME-P 5-8	500 - 800 Lts	304	500	715	10
FI-LME-P 8-13	800 - 1300 Lts	400	885	1100	13